

WASTE INCINERATION PLANT

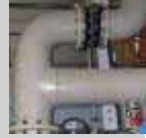

Technical data

Piping material: PP

CHEMICAL STORAGE

deliver → store → dosing



- **Truck Delivery station**

Built by regulation, adapted to the requirements of the customer

- **Chemical storage tanks**

Built by regulation, adapted to the requirements of the customer

- **Dosing**

Built by regulation, adapted to the requirements of the customer

Field of application

- Sewage and waste treatment plants
- Food industry
- Chemistry, biochemistry, pharmaceutical
- Environmental technology
- Water treatment
- Swimming pools
- Electroplating and anodised finishes



SOIL RECYCLING TRUCK DELIVERY



Material: PP

Construction: 2011

Medium: various chemicals

Dimensionen: Ø200-140 PN10

Verfahren: Mirror-welding
Hot gas welding
Sleeve welding

SOIL RECYCLING DOSAGE FROM DELIVERY TANK



Material: PE-100

Construction: 2011

Medium: Sulfuric acid
H₂SO₄ 70% 20m³
Caustic soda
H₂O₂ 40% 20m³
Iron(III)chlorid
FeCl₃ 30m³

WASTE INCINERATION DOSAGE FROM IBC CONTAINER



Material: PP / PTFE

Construction: 2011

Medium: Hydrogen peroxide
H₂O₂ 14% 2x1.2m³

SEWAGE PLANT DOSING



Material: PP / PVC / EPDM

Construction: 2011

Medium: Iron(III)chlorid FeCl_3

Pump: 4x DDI222-60D
4x DDAsmart

PIPELINE CONSTRUCTION



- **Process piping**

Piping for the business processes in industry

- **Piping in the chemical**

Piping for the conveyance of highly corrosive chemicals

- **Piping for Individual**

Piping adapted to the requirements of the customer

Field of application

- Sewage and waste treatment plants
- Food industry
- Chemistry, biochemistry,
pharmaceutical
- Environmental technology
- Water treatment
- Swimming pools
- Electroplating and anodised finishes

POWERSTATION GRIMSEL 2 COLD WATER DISTRIBUTION



Material: PE-100 SDR 17
PN10

Construction: 2011

Medium: Glacier water

Dimensions: Ø560

Process: Mirror welding
Electrofusion welding
Hot gas welding
Wüerstelschweissen

POWERSTATION GRIMSEL 2 COLD WATER DISTRIBUTION



Material: PE-100 SDR 17 PN10

Ausführung: 2011

Medium: Glacier water

Dimensionen: Ø20 to Ø560 round
350m

Verfahren: Mirror welding
Electrofusion welding
Hot gas welding
Wüerstelschweissen

BATTERIE RECYCLING PROCESS LINES



Material: PP SDR33 / EPDM

Construction: 2011

Medium: diverse

Dimensions: Ø200 bis Ø500

Process: Mirror welding
Hot gas welding
Wüerstelschweissen

MERCURY RECOVERY COLD WATER LINE



Material: PE 100 SRD17 PN10

Construction: 2011

Medium: various

Dimensions: Ø125 bis Ø355

Process: Mirror welding
Hot gas welding
Electrofusion welding

MERCURY RECOVERY PROCESS PIPE



Material: PE 100 SDR17 PN10

Construction: 2011

Medium: various

Dimensions: Ø125 bis Ø355

Process: Mirror welding
Hot gas welding
Electrofusion welding

WASTE INCINERATION HYDROXIDE MUD SPLASHDOWN



Material: PE SDR11 PN10

Construction: 2011

Medium: various

Dimensions: various

Process: Mirror welding
Sleeve welding
Hot gas welding

UNDERGROUND



- **Earth-tube collector**

Pipes for the conveyance of geothermal/cool

- **Air-transport pipelines**

Pipes for pumping of air

- **Chemical pipelines**

Pipes

- **Liquid-transport pipelines**

Pipes for the pumping of highly corrosive

Einsatzgebiete

- Minergie
- Comfort ventilation
- Environmental technology
- Multi-purpose halls
- Industry

FUNCTIONAL PRINCIPLE

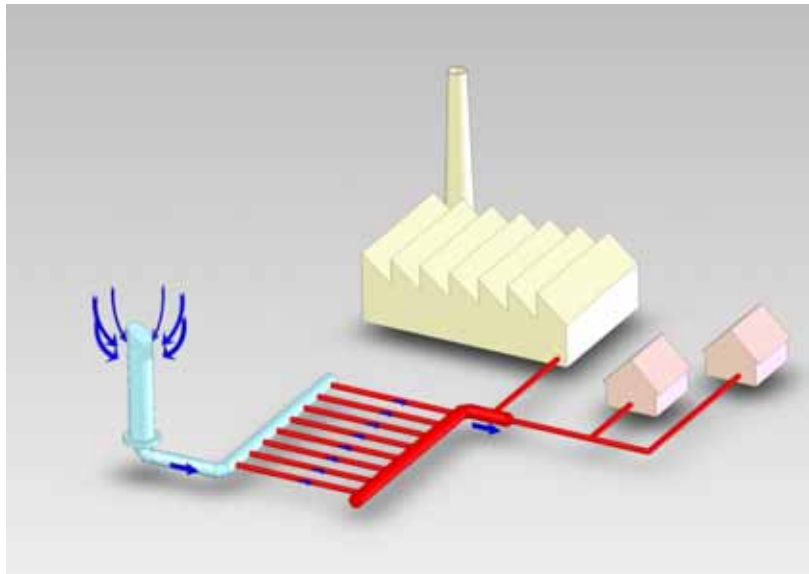

- Material:** PE-HD welded
- Air speed:** under 2m/s
- Length total:** min. 35m
- Deep editorial:** min. 2m over the surface
- Ground temperature in 2m:** 6-14°C Winter/Summer *
- Ground temperature in 6m:** 8-12°C Winter/Summer *

*=please note geological report

The ground temperature can be used as follows:

- at low temperatures, the cold air is heated in the ground
- at high temperatures, the warm air is cooled in the ground

In both directions energy is exchanged.

SPORTS ARENA EARTH-TUBE COLLECTOR HARP



Material: PE 100 welded

Construction: 2009

Medium: Air

Dimensions:

Ø450	157m
Ø500	125m
Ø180	184m
Ø110	330m

Process: Mirror welding
Electrofusion welding
Hot gas welding

MINERGIE HOUSE EARTH-TUBE COLLECTOR



Material: PE 100 geschweisst

Construction: 2007

Dimensions: Ø160 4m
Ø140 35m

SPORTS HALL DISTRIBUTION PIPELINE UNDERGROUND



Material: PE 100 welded

Construction: 2008

Dimensions: Ø560 97m

SCOOOL HOUSE DISTRIBUTION PIPELINE UNDERGROUND



Material: PE 100 welded

Construction: 2009

Medium: Air

Dimensions: Ø450 157m
Ø500 125m
Ø180 184m
Ø110 330m

Process: Mirror welding
Electrofusion welding
Hot gas welding

TRANSFORMER HOUSE COOLING PIPELINE UNDERGROUND



Material: PE 100 welded

Construction: 2009

Dimensions: Ø315 190m

SCCHOOLHOUSE COMFORT COOLING CONCRETED



Material: PE 100 welded

Construction: 2011

Medium: Air

Dimensions: Ø630 12m
Ø450 60m

Process: Mirror welding
Electrofusion welding
Hot gas welding

HOTEL COMFORT COOLING UNDERGROUND



Material: PE 100 welded

Construction: 2011

Medium: Air

Dimensions:

Ø1000	104m
Ø 800	8m
Ø 500	21m
Ø 315	16m

Process: Mirror welding
Electrofusion welding
Hot gas welding

MULTIPURPOSE BUILDING COMFORT COOLING IN BASE



Material: PE SDR33 welded

Construction: 2011

Medium: Air

Dimensions: Ø800 270m

COMFORT COOLING SILENCER UNDERGROUND

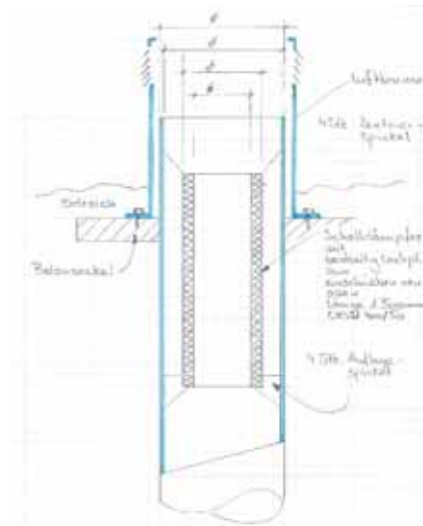

Material: PE 100 welded

Medium: Air

Dimensions: Ø200 Ø1200mm

REFUSE INCINERATION PLANT



Piping for a NOX-washer

Piping material: PP / GFK

REFUSE INCENERATION PLANT



Technical data

Piping material: PP / GFK

REFUSE INCENERATION PLANT



Technical data

Piping material: PP / GFK